

UNRECTED  
 MAY 21 1951  
 MAY 21 1975  
 MAY 28 1975  
 MAY 29 1975

Dwg. No.: T 65  
 Source: Taxation Maps Bureau  
 By: I.K.H. - Nov. 6, 1939.

KAMOKU STREET  
 PLAT 13

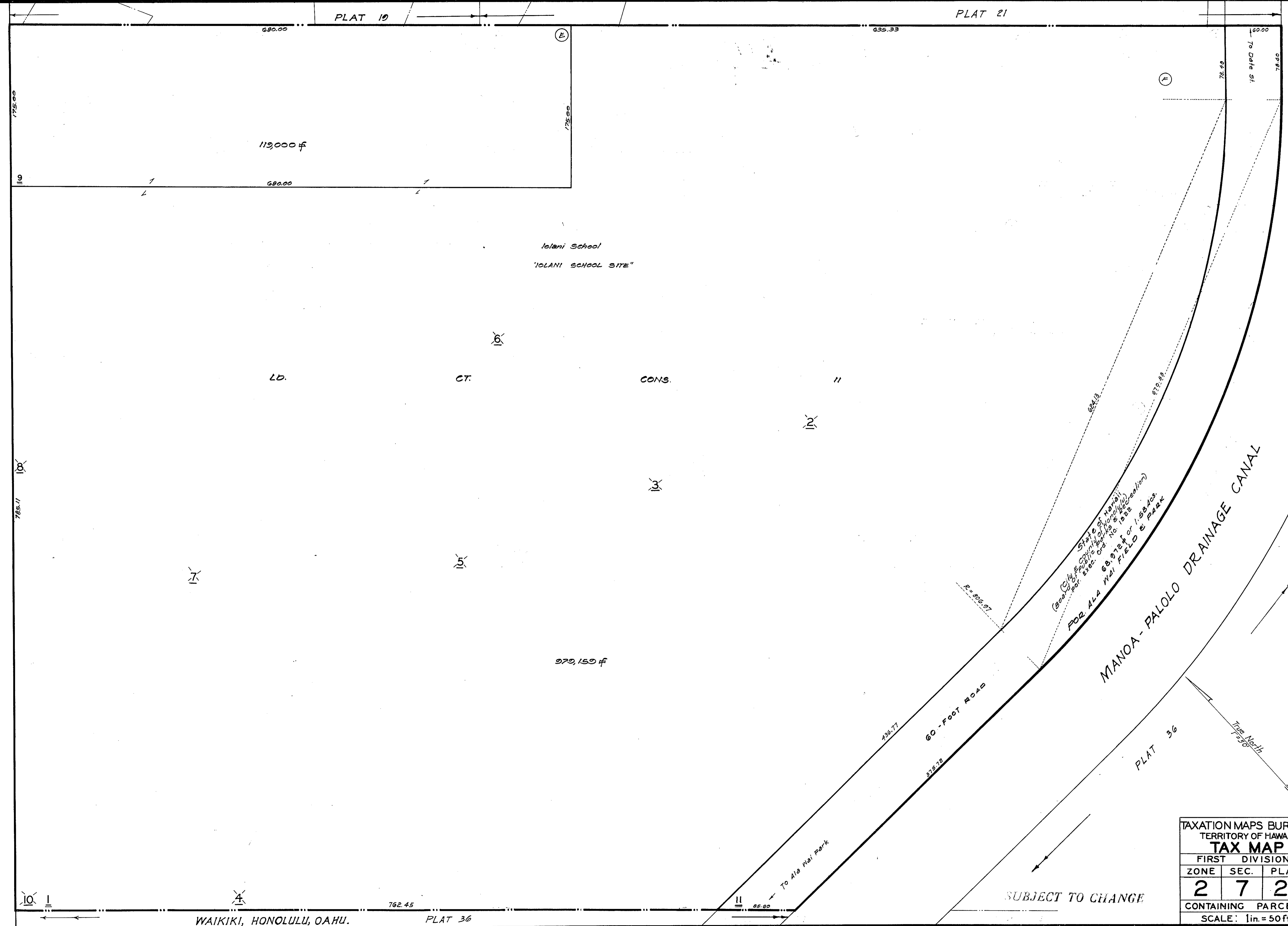

TAXATION MAPS BUREAU		
TERRITORY OF HAWAII		
<b>TAX MAP</b>		
FIRST DIVISION		
ZONE	SEC.	PLAT
2	7	20
CONTAINING PARCELS		
SCALE: 1 in. = 50 ft.		

SUBJECT TO CHANGE